



HAVE A BRILLIANT FUTURE

Motorcycle sports helmets

INTRODUCTION

ZhaoQing BoHan Sports Company Ltd. founded in 2002, focuses on the production of motorcycle helmets, electric vehicle helmets and various outdoor sports helmets. The products have passed the relevant safety certification. The company also invested millions of yuan to set up its own helmet laboratory, and has international professional testing equipment to provide qualified safety assurance for each product leaving the factory.

Cooperative customers: Meituan, Lulemai, Yonghui Life, JD Express, Didi Valet and E-Valet helmets are designed and produced by our company

Sponsored events: Qinghai Lake Tour, China Road Cycling Race, South Island Tour, HEROS China Cycling Series, Ironman League, etc

Sponsored teams: Yunnan Provincial Team, Shandong Team, Beijing XDS Team, Qinghai Tianyoude Team, Austria Frabel Professional Team, Spanish Team, etc

University sponsorship: Jiangnan University, Datong University, Xiamen University, Chuhan University, etc



AMY
CEO

It has operated the factory for 20 years, with 5 companies worldwide, and is good at product innovation and brand promotion; It combines beauty with wisdom, tradition with innovation.

OWN PRODUCTION BASE



Shunde MOON Helmet Headquarters



MOON's brand subordinate Feiko
Zhaoqing headquarters and production base

OWN TESTING LABORATORY





PRODUCT CATEGORY

OFF ROAD CROSS HELMET----- 04

ENDURO HELMET----- 05

ON ROAD FLIP-UP HELMET----- 09

ON ROAD FULL FACE----- 13

HALF FACE HELMET----- 23

OPEN FACE HELMET----- 25

VEST----- 31

KU129

DOUBLE VISORS OF TOUR-CROSS

- ABS Shell constructed that weights 1400g (± 50 g)
- Shell-integrated spoiler
- Height adjustable helmet shield
- Moisture-wicking, removable/washable air channeled comfort liner is there
- Vent holes for optimal ventilation
- Integrated face shield with UV protection
- Padded chin strap with double-D safety lock or quicky release buckle
- Designed for Street, Enduro and Adventure Bike Ride
- Replacement parts available
- Meets DOT safety standards

Adult: S(56) M(58) L(60) XL(62) cm

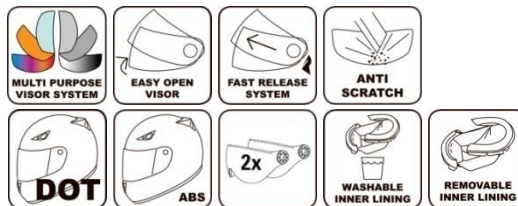



KU901

CROSS HELMET

- CARBON FIBER Shell constructed that weights 1300g (±50g)
- Shell-integrated spoiler
- Height adjustable helmet shield
- Moisture-wicking, removable/washable air channeled comfort liner is there
- Vent holes for optimal ventilation
- Padded chin strap with double-D safety lock or quicky release buckle
- Designed for Street, Enduro and Adventure Bike Ride
- Replacement parts available
- Meets CCC safety standards

Adult: M(57-58) L(59-60) XL(61-62) XXL(63-64)cm



KS05

CROSS HELMET

- CARBON FIBER Shell constructed that weights 780g (± 50 g)
- Shell-integrated spoiler
- Height adjustable helmet shield
- Moisture-wicking, removable/washable air channeled comfort liner is there
- Vent holes for optimal ventilation
- Padded chin strap with double-D safety lock or quicky release buckle
- Designed for Street, Enduro and Adventure Bike Ride
- Replacement parts available
- Meets CCC safety standards

Adult: XS(54-55) S(56-57) M(57-58) L(59-60) XL(61-62) XXL(63-64)cm



KS06

CROSS HELMET

- GLASS FIBER Shell constructed that weights 1300g (± 50 g)
- Shell-integrated spoiler
- Height adjustable helmet shield
- Moisture-wicking, removable/washable air channeled comfort liner is there
- Vent holes for optimal ventilation
- Padded chin strap with double-D safety lock or quicky release buckle
- Designed for Street, Enduro and Adventure Bike Ride
- Replacement parts available
- Meets CCC safety standards

Adult: XS(54-55) S(56-57) M(57-58) L(59-60) XL(61-62) XXL(63-64)cm



FK301

CROSS HELMET

- ABS Shell constructed that weights 1400g (± 50 g)
- Shell-integrated spoiler
- Height adjustable helmet shield
- Moisture-wicking, removable/washable air channeled comfort liner is there
- Vent holes for optimal ventilation
- Padded chin strap with double-D safety lock or quicky release buckle
- Designed for Street, Enduro and Adventure Bike Ride
- Replacement parts available
- Meets CCC safety standards

Adult: XS(54-55) S(56-57) M(57-58) L(59-60) XL(61-62) XXL(63-64)cm



KU965A

DOUBLE VISORS OF FLIP-UP HELMET

- ABS Shell constructed that weights 1590g (± 50 g)
- Shell-integrated spoiler
- Height adjustable helmet shield
- Moisture-wicking, removable/washable air channeled comfort liner is there
- Vent holes for optimal ventilation
- Integrated face shield with UV protection
- Padded chin strap with double-D safety lock or quicky release buckle
- Designed for Street, Enduro and Adventure Bike Ride
- Replacement parts available
- Meets DOT safety standards

Adult: S(56) M(58) L(60) XL(62) cm

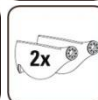

KU112H

DOUBLE VISORS OF FLIP-UP HELMET

- ABS Shell constructed that weights 1590g (± 50 g)
- Shell-integrated spoiler
- Height adjustable helmet shield
- Moisture-wicking, removable/washable air channeled comfort liner is there
- Vent holes for optimal ventilation
- Integrated face shield with UV protection
- Padded chin strap with quicky release buckle
- Designed for Street, Enduro and Adventure Bike Ride
- Replacement parts available
- Meets DOT safety standards

Adult: S(56) M(58) L(60) XL(62) cm

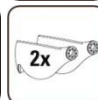

KU105

DOUBLE VISORS OF FLIP-UP HELMET

- ABS Shell constructed that weights 1590g (± 50 g)
- Shell-integrated spoiler
- Height adjustable helmet shield
- Moisture-wicking, removable/washable air channeled comfort liner is there
- Vent holes for optimal ventilation
- Integrated face shield with UV protection
- Padded chin strap with quicky release buckle
- Designed for Street, Enduro and Adventure Bike Ride
- Replacement parts available
- Meets DOT safety standards

Adult: S(56) M(58) L(60) XL(62) cm

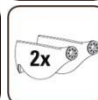

KU935

FLIP-UP HELMET

- ABS Shell constructed that weights 1590g (± 50 g)
- Shell-integrated spoiler
- Height adjustable helmet shield
- Moisture-wicking, removable/washable air channeled comfort liner is there
- Vent holes for optimal ventilation
- Integrated face shield with UV protection
- Padded chin strap with quicky release buckle
- Designed for Street, Enduro and Adventure Bike Ride
- Replacement parts available
- Meets DOT safety standards

Adult: S(56) M(58) L(60) XL(62) cm





FK112

FLIP-UP HELMET

- ABS Shell constructed that weights 1590g (± 50 g)
- Shell-integrated spoiler
- Height adjustable helmet shield
- Moisture-wicking, removable/washable air channeled comfort liner is there
- Vent holes for optimal ventilation
- Integrated face shield with UV protection
- Padded chin strap with quicky release buckle
- Designed for Street, Enduro and Adventure Bike Ride
- Replacement parts available
- Meets DOT safety standards

Adult: S(56) M(58) L(60) XL(62) cm



KU117

RACING HELMET

- CARBON FIBER Shell constructed that weights 1590g (±50g)
- Shell-integrated spoiler
- Height adjustable helmet shield
- Moisture-wicking, removable/washable air channeled comfort liner is there
- Vent holes for optimal ventilation
- Integrated face shield with UV protection
- Padded chin strap with double-D safety lock
- Designed for Street, Enduro and Adventure Bike Ride
- Replacement parts available
- Meets DOT and ECE 22.05 safety standards

Adult: M(58) L(60) XL(62) XXL(64)cm

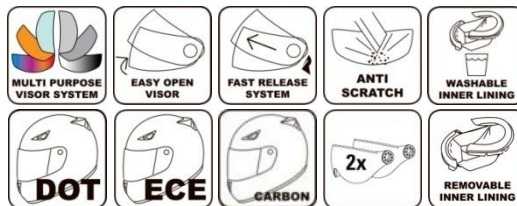

FK108

ALL TERRAIN FULL FACE HELMET



- ABS Shell constructed that weights 1500g (±50g)
- Shell-integrated spoiler
- Height adjustable helmet shield
- Moisture-wicking, removable/washable air channeled comfort liner is there
- Vent holes for optimal ventilation
- Integrated face shield with UV protection
- Padded chin strap with double-D safety lock or quickly release buckle
- Designed for Street, Enduro and Adventure Bike Ride
- Replacement parts available
- Meets DOT and ECE 22.05, CCC safety standards

Adult: XS(54) S(56) M(58) L(60) XL(62) XXL(64)cm
Kids: S(48) M(50) L(52) XL(54)cm

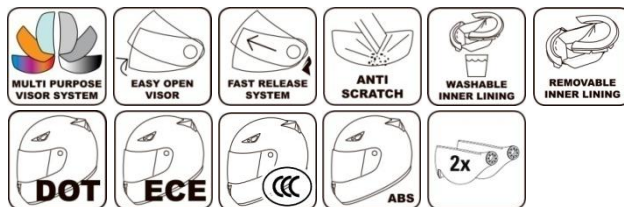



FK218

DOUBLE VISORS

- ABS Shell constructed that weights 1500g (±50g)
- Shell-integrated spoiler
- Height adjustable helmet shield
- Moisture-wicking, removable/washable air channeled comfort liner is there
- Vent holes for optimal ventilation
- Integrated face shield with UV protection
- Padded chin strap with quicky release buckle
- Designed for Street, Enduro and Adventure Bike Ride
- Replacement parts available
- Meets DOT and ECE 22.05, CCC safety standards

Adult: M(58) L(60) XL(62) XXL(64)cm

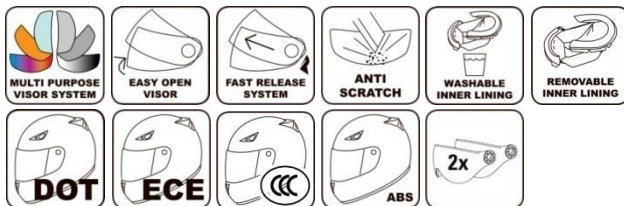



KU111

FULL FACE HELMET

- ABS Shell constructed that weights 1500g (± 50 g)
- Shell-integrated spoiler
- Height adjustable helmet shield
- Moisture-wicking, removable/washable air channeled comfort liner is there
- Vent holes for optimal ventilation
- Integrated face shield with UV protection
- Padded chin strap with quicky release buckle
- Designed for Street, Enduro and Adventure Bike Ride
- Replacement parts available
- Meets DOT and ECE 22.05 safety standards

Adult: M(58) L(60) XL(62) XXL(64)cm



MULTI PURPOSE
VISOR SYSTEM



EASY OPEN
VISOR



FAST RELEASE
SYSTEM



ANTI
SCRATCH



DOT



ECE



ABS



WASHABLE
INNER LINING



REMOVABLE
INNER LINING



ON ROAD FULL FACE

KUUVI helmet



Control button



Speaker



EMBEDDED
AUDIO

Type-C

Switch

KU636



SMART BLUETOOTH INTEGRATED TECHNOLOGY

- Has integrated Bluetooth technology aptx, SBC, and AAC audio codecs support
- Speakers built into Ear Flaps
- Includes built in lithium battery that recharges using Type-C
- Voice Control: AI voice assistant
- ABS Shell constructed that weights 1580g (± 50 g)
- Height adjustable helmet shield
- Moisture-wicking, removable/washable air channeled comfort liner is there
- Vent holes for optimal ventilation
- Integrated face shield with UV protection
- Padded chin strap with quicky release buckle
- Designed for Street, Enduro and Adventure motorcycle Ride
- Replacement parts available
- Meets DOT, ECE and CCC safety standards

Adult: M(58) L(60) XL(62) XXL(64)cm

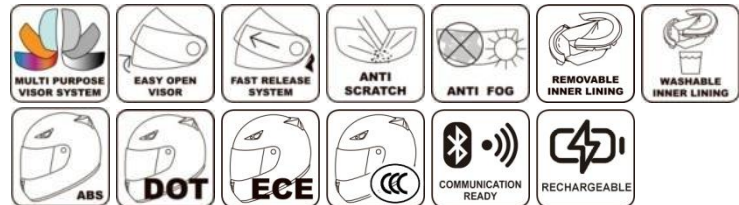



KU936

DOUBLE VISORS and LARGE TAIL WING

- CARBON FIBER Shell constructed that weights 1500g (± 50 g)
- Shell-integrated spoiler
- Height adjustable helmet shield
- Moisture-wicking, removable/washable air channeled comfort liner is there
- Vent holes for optimal ventilation
- Integrated face shield with UV protection
- Padded chin strap with quicky release buckle
- Designed for Street, Enduro and Adventure Bike Ride
- Replacement parts available
- Meets DOT and ECE 22.05 safety standards

Adult: M(57-58) L(59-60) XL(61-62) XXL(63-64)cm

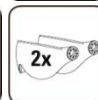
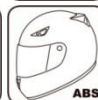

KU07-T

FULL FACE HELMET FOR HALEY STYLE

- CARBON FIBER Shell constructed that weights 1390g (±50g)
- Shell-integrated spoiler
- Height adjustable helmet shield
- Moisture-wicking, removable/washable air channeled comfort liner is there
- Vent holes for optimal ventilation
- Integrated face shield with UV protection
- Padded chin strap with double-D safety lock or quicky release buckle
- Designed for Street, Enduro and Adventure Bike Ride
- Replacement parts available
- Meets DOT and ECE 22.05, CCC safety standards

Adult: M(58) L(60) XL(62) XXL(64)cm

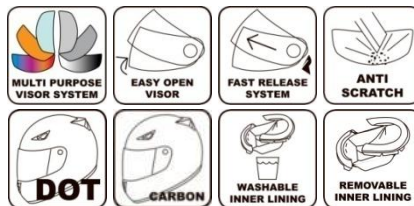



KU07

FULL FACE HELMET FOR HALEY STYLE

- GLASS FIBER Shell constructed that weights 1465g (± 50 g)
- Shell-integrated spoiler
- Height adjustable helmet shield
- Moisture-wicking, removable/washable air channeled comfort liner is there
- Vent holes for optimal ventilation
- Integrated face shield with UV protection
- Padded chin strap with double-D safety lock or quicky release buckle
- Designed for Street, Enduro and Adventure Bike Ride
- Replacement parts available
- Meets DOT and ECE 22.05, CCC safety standards

Adult: M(58) L(60) XL(62) XXL(64)cm



KU800

CARBON FIBER 3K



- CARBON FIBER Shell constructed that weights 1250g (±50g)
- Shell-integrated spoiler
- Height adjustable helmet shield
- Moisture-wicking, removable/washable air channeled comfort liner is there
- Vent holes for optimal ventilation
- Integrated face shield with UV protection
- Padded chin strap with double-D safety lock or quicky release buckle
- Designed for Street, Enduro and Adventure Bike Ride
- Replacement parts available
- Meets CCC safety standards

Adult: M(57-58) L(59-60) XL(61-62) XXL(63-64)cm





FF07

CARBON FIBER 3K

- CARBON FIBER Shell constructed that weights 1250g (±50g)
- Shell-integrated spoiler
- Height adjustable helmet shield
- Moisture-wicking, removable/washable air channeled comfort liner is there
- Vent holes for optimal ventilation
- Integrated face shield with UV protection
- Padded chin strap with double-D safety lock or quicky release buckle
- Designed for Street, Enduro and Adventure Bike Ride
- Replacement parts available
- Meets CCC safety standards

Adult: M(57-58) L(59-60) XL(61-62) XXL(63-64)cm





KU500

CARBON FIBER 3K

- ABS Shell constructed that weights 350g (±50g)
- Shell-integrated spoiler
- Height adjustable helmet shield
- Moisture-wicking, removable/washable air channeled comfort liner is there
- Integrated face shield with UV protection
- Padded chin strap with quicky release buckle
- Designed for Street, Enduro and Adventure Bike Ride
- Replacement parts available
- Meets CCC safety standards

Adult: M(57-58) L(59-60) XL(61-62) XXL(63-64)cm



FG-01

FOR HALEY STYLE



- ABS Shell constructed that weights 600g (± 50 g)
- Shell-integrated spoiler
- Height adjustable helmet shield
- Moisture-wicking, removable/washable air channeled comfort liner is there
- Integrated face shield with UV protection
- Padded chin strap with double-D safety lock or quicky release buckle
- Designed for Street, Enduro and Adventure Bike Ride
- Replacement parts available
- Meets DOT safety standards

Adult: M(57-58) L(59-60) XL(61-62) XXL(63-64)cm



BH03

¾ HELMET

- ABS Shell constructed that weights 550g (±50g)
- Shell-integrated spoiler
- Height adjustable helmet shield
- Moisture-wicking, removable/washable air channeled comfort liner is there
- Vent holes for optimal ventilation
- Integrated face shield with UV protection
- Padded chin strap with double-D safety lock or quicky release buckle
- Designed for Street, Enduro and Adventure Bike Ride
- Replacement parts available
- Meets DOT safety standards

Adult: XS(54-55) S(56-57) M(57-58) L(59-60) XL(61-62) XXL(63-64)cm

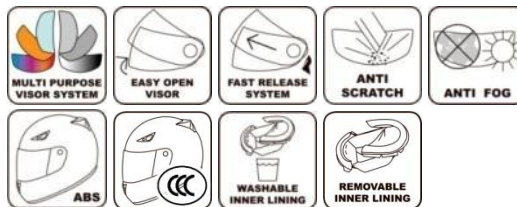

FK110

¾ HELMET

- ABS Shell constructed that weights 550g (±50g)
- Shell-integrated spoiler
- Height adjustable helmet shield
- Moisture-wicking, removable/washable air channeled comfort liner is there
- Vent holes for optimal ventilation
- Integrated face shield with UV protection
- Padded chin strap with double-D safety lock or quickly release buckle
- Designed for Street, Enduro and Adventure Bike Ride
- Replacement parts available
- Meets DOT safety standards

Adult: XS(54-55) S(56-57) M(57-58) L(59-60) XL(61-62) XXL(63-64)cm

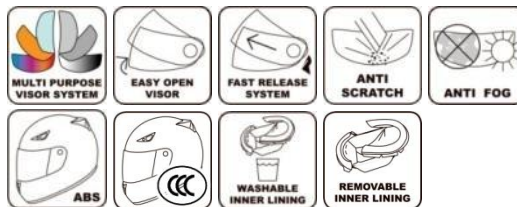

KU08

¾ HELMET FOR HALEY STYLE

- GLASS FIBER Shell constructed that weights 1250g (±50g)
- Shell-integrated spoiler
- Height adjustable helmet shield
- Moisture-wicking, removable/washable air channeled comfort liner is there
- Vent holes for optimal ventilation
- Integrated face shield with UV protection
- Padded chin strap with double-D safety lock or quicky release buckle
- Designed for Street, Enduro and Adventure Bike Ride
- Replacement parts available
- Meets DOT safety standards

Adult: XS(54-55) S(56-57) M(57-58) L(59-60) XL(61-62) XXL(63-64)cm





KU08-B

¾ HELMET FOR VISORS

- GLASS FIBER Shell constructed that weights 1250g (±50g)
- Shell-integrated spoiler
- Integrated face shield
- Moisture-wicking, removable/washable air channeled comfort liner is there
- Vent holes for optimal ventilation
- Padded chin strap with double-D safety lock or quicky release buckle
- Designed for Street, Enduro and Adventure Bike Ride
- Replacement parts available
- Meets DOT safety standards

Adult: XS(54-55) S(56-57) M(57-58) L(59-60) XL(61-62) XXL(63-64)cm



FG-02

¾ HELMET FOR HALEY STYLE



- ABS Shell constructed that weights 1590g (±50g)
- Shell-integrated spoiler
- Height adjustable helmet shield
- Moisture-wicking, removable/washable air channeled comfort liner is there
- Vent holes for optimal ventilation
- Integrated face shield with UV protection
- Padded chin strap with double-D safety lock or quicky release buckle
- Designed for Street, Enduro and Adventure Bike Ride
- Replacement parts available
- Meets DOT safety standards

Adult: S(56) M(58) L(60) XL(62) XXL(64)cm



FK01

¾ HELMET FOR HALEY STYLE

- ABS Shell constructed that weights 1590g (±50g)
- Shell-integrated spoiler
- Height adjustable helmet shield
- Moisture-wicking, removable/washable air channeled comfort liner is there
- Vent holes for optimal ventilation
- Integrated face shield with UV protection
- Padded chin strap with double-D safety lock or quicky release buckle
- Designed for Street, Enduro and Adventure Bike Ride
- Replacement parts available
- Meets DOT safety standards

Adult: S(56) M(58) L(60) XL(62) XXL(64)cm





KU600

¾ HELMET FOR CARBON FIBER 3K

- CARBON FIBER Shell constructed that weights 950g (±50g)
- Shell-integrated spoiler
- Height adjustable helmet shield
- Moisture-wicking, removable/washable air channeled comfort liner is there
- Integrated face shield with UV protection
- Padded chin strap with quicky release buckle
- Designed for Street, Enduro and Adventure Bike Ride
- Replacement parts available
- Meets CCC safety standards

Adult: XS(54-55) S(56-57) M(57-58) L(59-60) XL(61-62) XXL(63-64)cm





ITV01

INFLATABLE THERMAL VEST

- Ultralight environmental protection, comfortable and warm
- Intelligent charging
- Wind and rain proof
- Fall protection, swimming and lifesaving
- Autumn and winter warmth
- Material: composite fabric, air bag, air valve, waterproof zipper
- Color: black
- Size: Average Size



WeChat



WhatsApp



ZhaoQing BoHan Sports Company Ltd.

Add: No. 2-1, Kang Tai Street, High-tech Zone, Zhaoqing City,
Guangdong Province, P.R. China

E-mail: info@moonhelmet.com

www.moonhelmet.com



0086-757-26331385